

#whdentalwerk



video.wh.com

Now at
your dealer
or wh.com



The most fantastic turbines

in the world from W&H



syneo



syneca VISION

The instrument range that meets the highest demands. High-end turbines with ultimate technology!



syneca FUSION

The instrument range for maximum economy. Proven Syneca quality is more accessible than ever before, whatever your budget!

Turbines that meet the highest demands

High-end technology for excellent preparation results: Both of the Syneca turbine lines are characterised by high performance, optimal ergonomics and outstanding value for money. Syneca Vision is symbolic of innovations such as the sterilizable 5x Ring LED+ and Syneca Fusion promises top quality combined with unbeatable cost-efficiency.

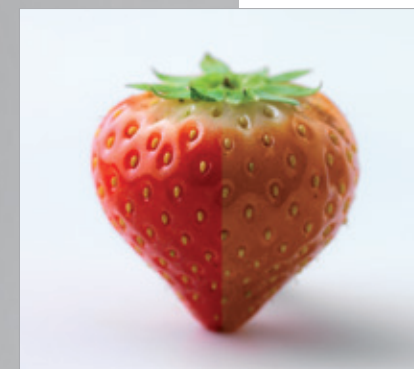

See better

Optimal contrast and natural illumination with maximal colour rendering with LED+.

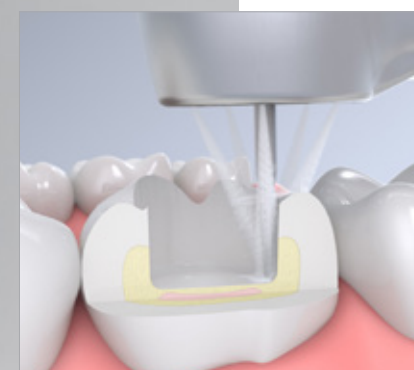

Optimum cooling

Thanks to the 4x or 5x spray, the bur tip is optimally cooled in every application position.



Patented hygienic head system

The circulating air in the turbine head ensures no aerosol particles are sucked into the turbine as the rotor slows down.

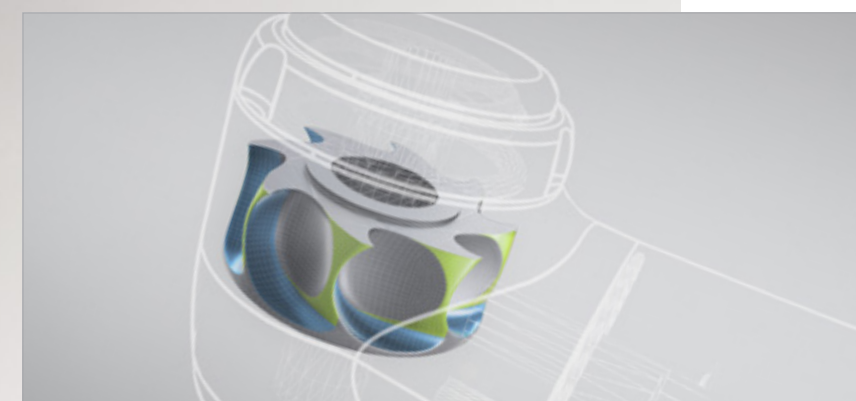

Full steam ahead with the Power Blade rotor

The optimized blade geometry allows higher rotor efficiency. For maximum torque and optimal power throughout preparation.



Ergonomic, lightweight and quiet

Relaxed, fatigue-free working with noticeably more lightweight turbine system.

Synea Vision:

The dream that has become reality

The world's first sterilizable turbine handpieces with 5x Ring LED+ not only amaze with their shadowless illumination, but prove to be turbines of the highest quality in all other respects too. Discover a completely new working experience – with absolutely no shadows.

synea^{VISION}

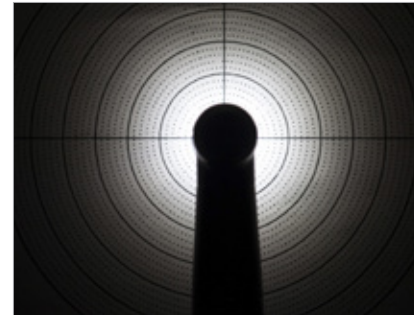

Synea Vision Ring LED+
Shadowless illumination of the treatment site with the unique 5x Ring LED+.

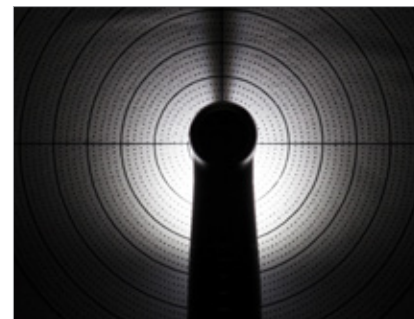

Synea Fusion in comparison with basic LED+.



Comfort to the power of 5!
Five LEDs and five spray ports revolutionise visual comfort and ease of use.

Synea Vision:

Power turbine TK-100 L
and microturbine TK-94 L

The TK-100 L is the power turbine with absolutely no shadows. It offers extra high performance without undesirable side effects such as high wear and tear or air escaping from the head of the turbine. With its extra small head, the TK-94 L is perfect for minimally invasive procedures and provides optimal access to the treatment site.



Tiny head, great advantages
With a head diameter of only 9 mm and an overall head height of 17.2 mm with a 16 mm bur attached patients with a limited access, such as children and the elderly, benefit especially.



Further advantages at a glance

- › Outstanding ergonomics
- › Low weight
- › Best balance
- › Non-slip grip profile
- › Especially quiet rotor
- › Low-noise operation
- › Ceramic ball bearings
- › Hygienic head system
- › Long service life
- › Quality made in Austria
- › Thermo washer disinfectable and sterilizable
- › 24 months warranty

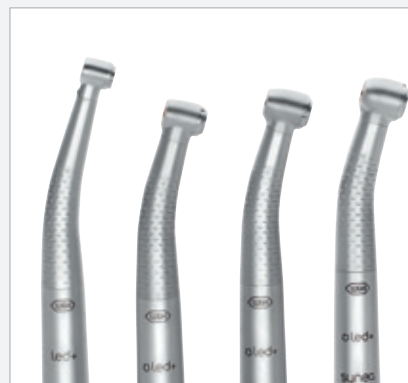

Tailor-made turbines
The right head size for optimal access to the treatment site in every application.



Extraordinary value retention
Like new every day with the special, scratch-resistant coating.

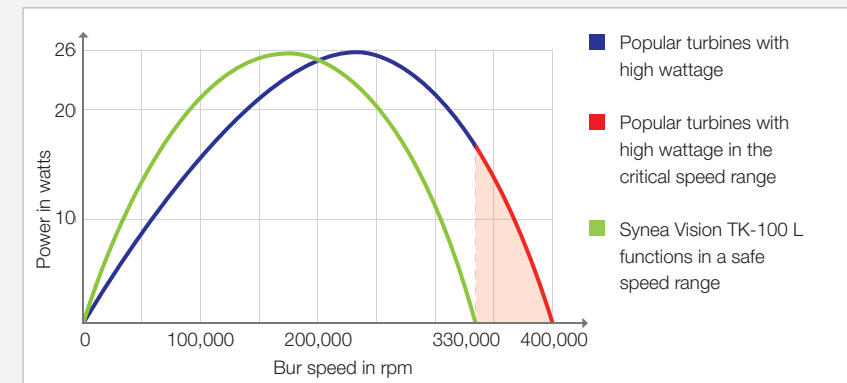

Service life with no compromises
Improved performance due to optimal use of the torque without exhausting the maximum speed. This reliably ensures high power and is gentle on the rotor's ball bearings for a long time.

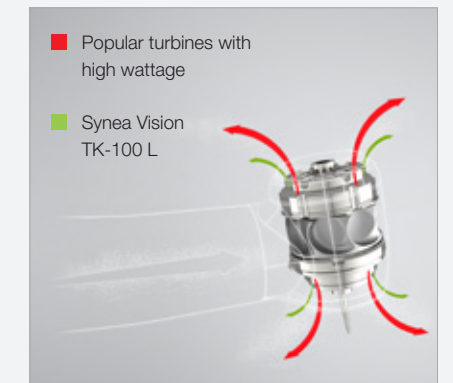

Hygiene with no compromises
Minimal escape of air at the head maximum capacity for added efficiency and unbeatable hygiene.

User experiences



Dr. med.dent. Martin Schiffli
Salzburg, Austria

“The innovative lighting concept of the W&H turbine with 5x Ring LED+ ensures full light intensity at the treatment point even under difficult conditions.”



Dr. Sunil Hirani
BSc (Hons), BDS, MSc, FDSRCS (Eng),
MOrthRCS (Eng), FDS (Orth)SmileLux,
Milton Keynes, United Kingdom

“The Synea Vision turbine is perhaps one of the best handpieces I have ever used. This is attributed to its lightweight, excellent torque and superb ring LED+ light source especially in very difficult to see areas in the posterior part of the mouth.”



DDR Mats Bäckström Falun
Sweden

“Excellent torque supports efficient removal of natural tooth substance as well as high-strength denture materials.”



Synea Vision: Technical data



Types with integrated ceramic ball bearings:	TK-94 L / TK-94 LM	TK-97 L / TK-97 LM	TK-98 L / TK-98 LM	TK-100 L / TK-100 LM
Light:	LED+ / compact glass rod	Ring LED+ / compact glass rod		
Coupling:	1 Roto Quick / 2 Multiflex®**			
Head size:	Ø 9 mm	Ø 10 mm	Ø 11,5 mm	Ø 13 mm
Head height:	17.2 mm (with bur 16 mm)	21.1 mm (with bur 19 mm)	21.4 mm (with bur 19 mm)	
Power*:	14 W	21 W	24 W	26 W
rpm (min⁻¹):	410,000 ± 30,000	400,000 ± 30,000	360,000 ± 30,000	330,000 ± 30,000
Rotary instruments:	FG bur, as per ISO 1797-1, with Ø 1,6 mm			
Max. operating part diameter:	1.5 mm	2 mm	2 mm	2.5 mm
Max. length:	16 mm	21 mm	25 mm	25 mm
Weight:	39 g / 67 g	38 g / 68 g	40 g / 69 g	40 g / 70 g
Roto Quick connection operating pressure:	3 ± 0,3 bar			
Multiflex® connection operating pressure:	2.5 to 4 bar			
Spray:	5x			

* Performance value applies at a rated pressure of 3 bar and exhaust air pressure of max. 0.2 bar

** Multiflex® is a trademark of a third party not affiliated with W&H Dentalwerk Bürmoos GmbH

1



W&H Roto Quick couplings enable the versatile use of instruments with Ring LED+, LED+, LED and halogen light

- › Click and pull
- › Continuous regulation of the spray water supply
- › Clean head system
- › Sterilizable
- › 24 months warranty

2



W&H RM-34 LED coupling for Multiflex® connection**

- › Use of LED without requiring changes to an optic dental unit
- › Long LED service life
- › Continuous regulation of the spray water supply
- › Clean head system
- › 24 months warranty

Synea Fusion:

Synea turbines with maximum efficiency

User comfort with no compromises and top performance combined with outstanding cost-efficiency: Discover the advantages of the Synea Fusion line!

Further advantages at a glance

- › Outstanding ergonomics
- › Low weight
- › Especially quiet rotor
- › Low-noise operation
- › Ceramic ball bearings
- › Hygienic head system
- › Long service life
- › Quality made in Austria
- › Thermo washer disinfectable and sterilizable
- › 12 months warranty



Optimum cooling of four sides
Constant cooling and optimal cleaning of the treatment site thanks to 4x spray.



Experience LED+
Excellent illumination with natural colour rendering and optimal positioning of the LED.



The choice is yours

Choose between the two different head sizes and then select the connection which suits your coupling system. The W&H Roto Quick offers you unbeatable LED+ light and convenient 360° rotation.



Synea Fusion:

Technical data



Types:	TG-97 L / TG-97 L RM / TG-97 LM / TG-97 L N / TG-97	TG-98 L / TG-98 L RM / TG-98 LM / TG-98 L N / TG-98
Light:	LED + / LED + / compact glass rod / compact glass rod / -	
Coupling:	1 Roto Quick: TG-97, TG-97 L RM-connection: TG-97 L RM 2 Multiflex®: TG-97 LM NSK Mach®: TG-97 L N	1 Roto Quick: TG-98, TG-98 L RM-connection: TG-98 L RM 2 Multiflex®: TG-98 LM NSK Mach®: TG-98 L N
Head size:	Ø 10 mm	Ø 11.5 mm
Head height:	21.1 mm (with bur 19 mm)	21.4 mm (with bur 19 mm)
Power*:	18 W	21 W
rpm (min ⁻¹):	390,000 ± 30,000	360,000 ± 30,000
Rotary instruments:	FG bur, as per ISO 1797-1, with Ø 1,6 mm	
Max. operating part diameter:	2 mm	2 mm
Max. length:	21 mm	25 mm
Weight:	40 g / 43 g / 68 g / 50 g / 40 g	40 g / 44 g / 70 g / 52 g / 42 g
Roto Quick connection operating pressure:	3 ± 0,3 bar	
Multiflex® connection operating pressure:	2.5 to 4 bar	
Spray:	4x	

* Performance value applies at a rated pressure of 3 bar and exhaust air pressure of max. 0.2 bar

** Multiflex® and NSK Mach® are trademarks of third parties not affiliated with W&H Dentalwerk Bürmoos GmbH



W&H Roto Quick couplings enable the versatile use of instruments with Ring LED+, LED+, LED and halogen light

- › Click and pull
- › Continuous regulation of the spray water supply
- › Clean head system
- › Sterilizable
- › 24 months warranty



W&H RM-34 LED coupling for Multiflex® connection

- › Use of LED without requiring changes to an optic dental unit
- › Long LED service life
- › Continuous regulation of the spray water supply
- › Clean head system
- › 24 months warranty

W&H AIMS
Safety first!

Hygiene is extremely important in the dental practice. W&H AIMS is here to help: with a wide product portfolio, fundamental knowledge and all relevant information at a glance.

For your safety and the safety of your patients. [aims.wh.com](https://www.aims.wh.com)

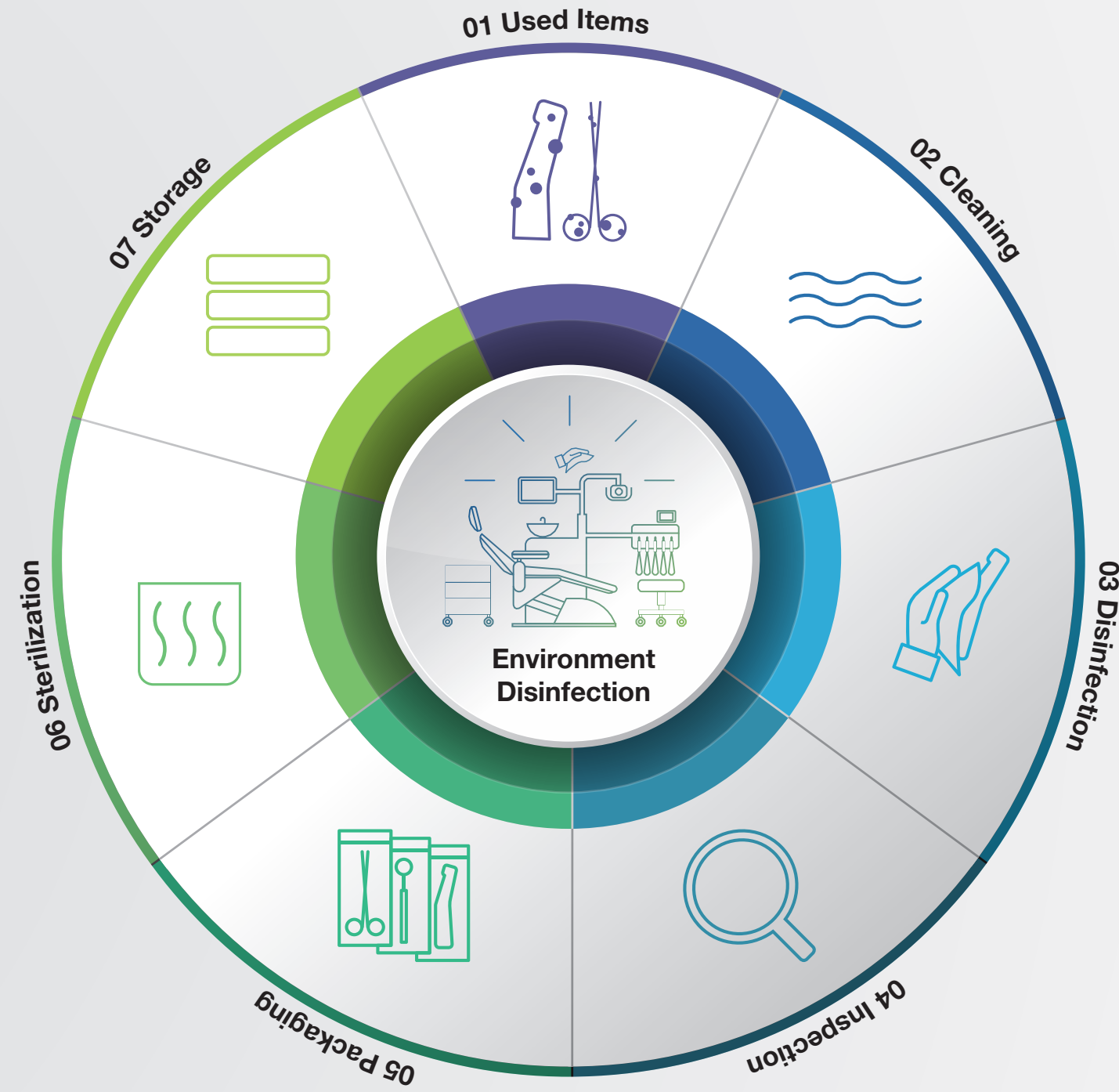

- 
Decontamination
- 
Cleaning
- 
Disinfection
- 
Inspection & Maintenance
- 
Packaging
- 
Sterilization
- 
Traceability & Storage

The most harmonic turbines

in the world from W&H



Pictures are for illustrative purposes only. Additional equipment and accessories shown are not included as standard.

Manufacturer:

W&H Dentalwerk Bürmoos GmbH
Ignaz-Glaser-Straße 53, Postfach 1
51111 Bürmoos, **Austria**
t +43 6274 6236-0
f +43 6274 6236-55
office@wh.com
wh.com

Distribution:

W&H (UK) Limited
6 Stroud Wood Business Centre
Park Street, St Albans, Hertfordshire AL2 2NJ, **United Kingdom**
t +44 1727 874990
f +44 1727 874628
office.uk@wh.com
wh.com



20392 UEN Rev. 010 / 06.03.2024
Subject to alterations